

IR3 Series

Industrial Rotating Warning Beacons

Versatile, medium size industrial warning beacon.

IR3 Series beacons are ideal for many in-plant visual signaling applications. With attention getting flash rates, these beacons are available in lower intensities appropriate for equipment and area status indication and higher intensities used for warning purposes.

These beacons offer high reliability using a minimum of parts and a rugged design that features sealed gear motors. When necessary, maintenance is fast and easy, saving labor and downtime.

FEATURES

- Four models offer a choice of incandescent or halogen lighting available in either 24 VDC and 120 VAC.
- Halogen Models with Long-Life Lamps.
- Sealed gear motors are rated for heavy duty, continuous operation.
- Elliptical dome shape provides highest light transmission and light output. Smooth outer surface minimizes dust and dirt collection.
- O-ring gasket between dome and base provides water-resistant seal.
- Non-corroding polycarbonate base with combination mount offers both permanent (flat) and 1 pipe mounting.
- Domes available in all five safety colors.

MODELS

- U.L. listed, models IR3120I & IR3120H.
- IR3024I, 24 volts DC with 25 watt incandescent lamp.
- IR3120I, 120 volts AC with 25 watt incandescent lamp, UL listed.
- IR3024H, 24 volts DC with 18 watt halogen lamp.
- IR3120H, 120 volts AC with 23 watt halogen lamp, UL listed.



Model IR3120H



IR3 Series

Specification Data

TECHNICAL SPECIFICATIONS

Model	Voltage	Current	FPM	Beam Candlepower	Lamp Wattage	Lamp Connection	Ambient Temperature	Mounting	Weight
Halogen									
IR3024H	24 VDC	1.0a	110	4300	18 w	Double Contact Bayonet Base	-35°C to 66°C	Combination Flat/Permanent & 1" NPT Pipe	1 lb. 4 oz.
IR3120H	120 VAC	.25a	90	6720	23 w				
Incandescent									
IR3024I	24 VDC	1.0a	90	2570	25 w	Double Contact Bayonet Base	-35°C to 66°C	Combination Flat/Permanent & 1" NPT Pipe	1 lb. 4 oz.
IR3120I	120 VAC	.25a	90	1000	25 w				

WHELEN
ENGINEERING COMPANY, INC.

REPLACEMENT PARTS

Description	Part Number	IR3024H	IR3120H	IR3024I	IR3120I
Lamps					
24VDC/25w Incandescent	34-0428050-6B			■	
120VAC/25w Incandescent	34-0412150-59				■
24VDC/18w Halogen	34-0022327-00	■			
120VAC/23w Halogen	34-0022326-00		■		
Motors					
24VDC	27-0241334-02	■		■	
120VAC	27-0216182-02		■		■
Domes					
Amber	02-0281402-10	■	■	■	■
Blue	02-0281402-20	■	■	■	■
Clear	02-0281402-30	■	■	■	■
Green	02-0281402-40	■	■	■	■
Red	02-0281402-50	■	■	■	■
"O" Ring Seal	38-0441331-00	■	■	■	■
Mounting Gasket	38-0241332-00	■	■	■	■

Printed in the U.S.A.
050701-IR3PB-10438B

EXPLODED VIEW

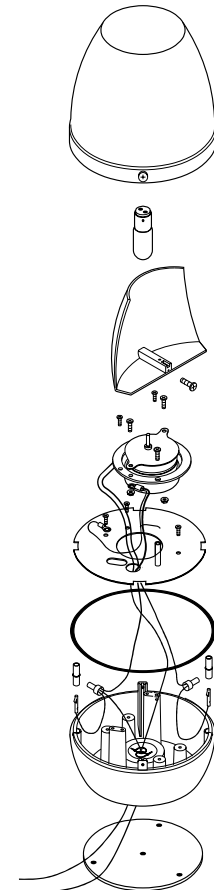

DIMENSIONS



CERTIFICATION

UL 1638 (IR3120I, IR3120H)